

Plasterboard fixing metal GKM

The self-tapping metal fixing for gypsum plasterboard and gypsum fibreboard



Wall lamps



Speaker cabinets

Applications

- Pictures
- Lighting
- Electrical installations
- Fitting accessories

Advantages

- Due to its material properties, the GKM can be used in gypsum plasterboard and gypsum fibreboard, and can be used with the most wide-ranging screws, hooks and eye screws. This allows for a broad range of applications.
- The sharp, self-tapping thread enables a secure, positive fit fixing. This achieves a high load-bearing capacity.

Building materials

- Gypsum fibreboard
- Gypsum plasterboard

- The cross-drive recess means that a standard screwdriver or bit can be used. No special setting tool is required.
- The short fixing length means that only a small amount of space is required behind the board. As a result, the GKM can also be used in the case of unknown board thickness and cavity depth.

Functioning

- The GKM is suitable for pre-positioned installation.
- The self-tapping metal fixing GKM taps itself into the plasterboard with a positive fit.
- Flush installation in the board building material. Overtightening the fixing should be avoided. Therefore, the installation torque should be limited when using a battery operated screwdriver.
- Adapted for wood, self-tapping and chip-board screws of 4.0 to 5.0 mm diameter.
- Pre-drill with a Ø 8 mm drill bit when using gypsum fibreboard and double-planked gypsum plasterboard.
- Not suitable for tiled plasterboard.

Installation GKM

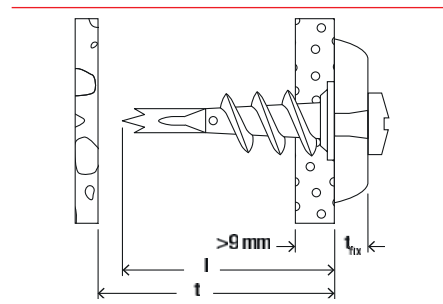
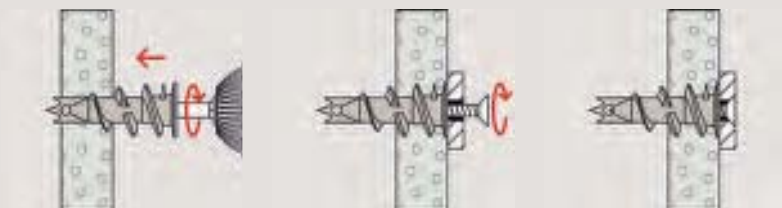

7

Technical data

Plasterboard fixing metal GKM



GKM

Item	Item No.	Anchor length	Min. thickness to first supporting layer	Max. fixture thickness	Screw	Drive	Sales unit
		l [mm]	t [mm]	t _{fix} [mm]			
GKM	024556	31	35	—	4,0 - 5,0 x Ls	—	100
GKM 12	040432 ¹⁾	31	35	12	4,5 x 35	PZ2	100
GKM 27	040434 ¹⁾	31	35	27	4,5 x 50	PZ2	100

¹⁾ Supplied with plasterboard screws countersunk head.

Loads

Plasterboard fixing metal GKM

Recommended loads¹⁾ for a single anchor.

Type	GKM	
Chipboard screw diameter	[mm]	4.0 - 5.0
Recommended loads in the respective base material F _{rec} ²⁾		
Gypsum plasterboard	9.5 mm	[kN] 0.07
Gypsum plasterboard	12.5 mm	[kN] 0.08
Gypsum plasterboard	2 x 12.5 mm	[kN] 0.11

¹⁾ Required safety factors are considered. The given loads are valid for chipboard screws with the specified diameters.

²⁾ Valid for tensile load, shear load and oblique load under any angle.