

Metal cavity fixing HM

The versatile metal cavity fixing with metric screws



Curtain rails



Shelves

7

Applications

- Pictures
- Lighting
- Light shelves
- Towel rails
- Mirror cabinets
- Curtain rails
- Sub-structures

Advantages

- Due to the extensive range, the HM is suitable for board building materials with a thickness of 3-50 mm and thus suitable for a number of different applications.
- The metric internal thread allows the attachment to be removed and refitted several times, thus offering the best possible flexibility.

- The HM's expanding arms ensure a large supporting surface, thus allowing a high load-bearing capacity.
- The claws around the edge of the fixing penetrate the board building material, preventing the fixing from rotating, thus ensuring a secure installation.

Building materials

- Gypsum plasterboard and gypsum fibreboards
- Cavity floor slabs
- Light building boards made of wood wool
- Chipboard
- Plywood boards

Functioning

- The metal cavity fixing HM is suitable for pre-positioned installation.
- The fixing should be selected based on the thickness of the board building material, to allow the very best expansion in the cavity.
- During installation, the expanding arms swing open and press onto the reverse side of the board.
- The HM can be installed using installation pliers. If using a battery operated screwdriver or screwdriver for installation, the pre-assembled screws must be removed first. When screwing in and expanding the fixing, the attachment, or a max. 6 mm plate, needs to be used as a turning stop.

Installation HM

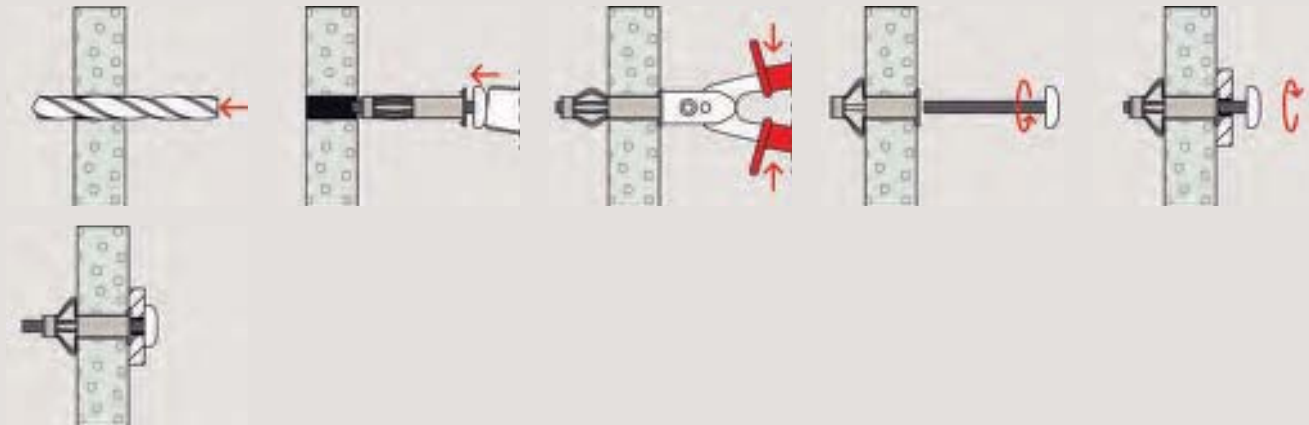

Installation HM

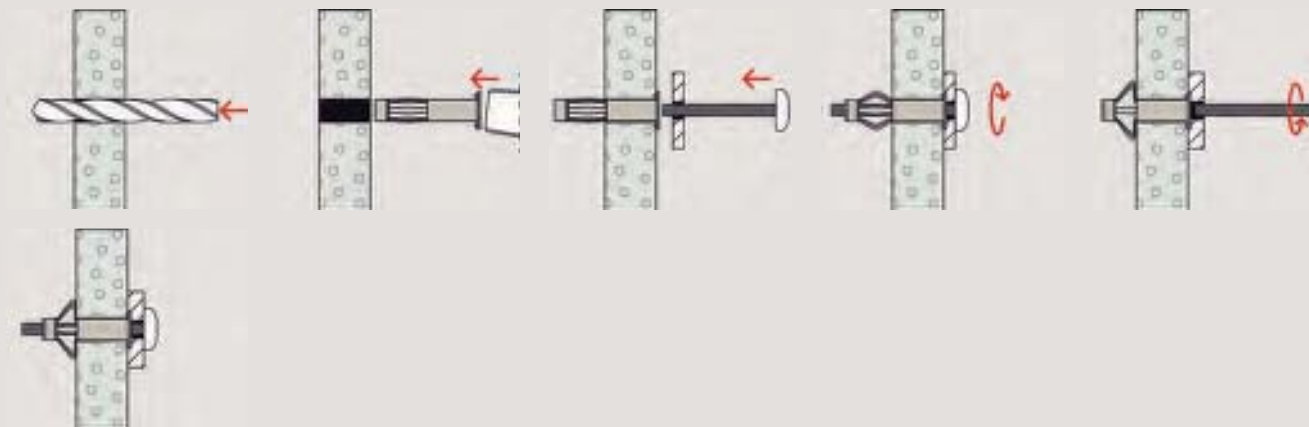

7

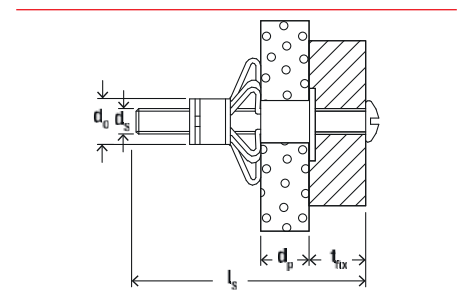

Technical data in board material

Metal cavity fixing HM



HM-S with metric screw

HM-SS with hexagon headed screw

HM-H with angle hook

Item	Item No.	Drill hole diameter d_0 [mm]	Min. drill hole depth h_1 [mm]	Anchor length l [mm]	Screw $d_s \times l_s$ [mm]	Panel thickness d_p [mm]	Fixture thickness t_{fix} [mm]	Drive	Sales unit [pcs]
HM 4 x 32 S	519769	8	40	32	M 4 x 40	3 - 13	≤ 15 - 25	PH2	50
HM 4 x 45 S	519770	8	52	45	M 4 x 52	16 - 23	≤ 12 - 21	PH2	50
HM 4 x 60 S	519771	8	65	60	M 4 x 65	31 - 40	≤ 12 - 21	PH2	50

1) with hexagon headed screw, assembly only by using the professional installation tool HM Z 1

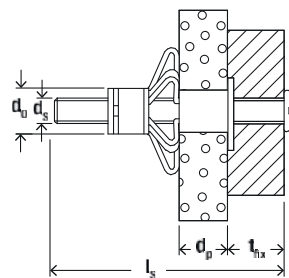

Technical data in board material

Metal cavity fixing HM



HM-S with metric screw

HM-SS with hexagon headed screw

HM-H with angle hook

Item	Item No.	Drill hole diameter d_0 [mm]	Min. drill hole depth h_1 [mm]	Anchor length l [mm]	Screw $d_s \times l_s$ [mm]	Panel thickness d_p [mm]	Fixture thickness t_{fix} [mm]	Drive	Sales unit [pcs]
HM 5 x 37 S	519772	10	45	37	M 5 x 45	6 - 15	≤ 8 - 17	PH2	50
HM 5 x 52 S	519774	10	58	52	M 5 x 58	7 - 21	≤ 10 - 24	PH2	50
HM 5 x 65 S	519775	10	71	65	M 5 x 71	20 - 34	≤ 12 - 26	PH2	50
HM 6 x 37 S	519777	12	45	37	M 6 x 45	6 - 15	≤ 12 - 21	PH3	50
HM 6 x 52 S	519778	12	58	52	M 6 x 58	7 - 21	≤ 14 - 28	PH3	50
HM 6 x 65 S	519782	12	71	65	M 6 x 71	17 - 34	≤ 13 - 30	PH3	50
HM 6 x 80 S	519779	12	88	80	M 6 x 88	32 - 50	≤ 16 - 34	PH3	50
HM 8 x 54 SS	519783 ¹⁾	12	60	54	M 8 x 60	7 - 21	≤ 16 - 30	SW13	50
HM 4 x 32 H	519780	8	45	32	—	3 - 13	—	—	50
HM 5 x 65 H	519781	10	71	65	—	20 - 34	—	—	50

¹⁾ with hexagon headed screw, assembly only by using the professional installation tool HM Z 1

Accessories

Installation pliers HMZ



HM Z 1 - the professional installation tool

HM Z 2 - the DIY installation tool

HM Z 3

Item	Item No.	Adapted for	Sales unit [pcs]
HM Z 1	062320	HM 4 - HM 8	1
HM Z 2	062321	HM 4 - HM 6	1
HM Z 3	539723	HM 4 - HM 6	1

Loads

Metal cavity fixing HM

Recommended loads¹⁾ for a single anchor.

Type			HM 4 x 32 S	HM 4 x 46 S	HM 5 x 37 S	HM 5 x 52 S	HM 5 x 65 S	HM 6 x 37 S	HM 6 x 52 S	HM 6 x 65 S	HM 8 x 55 SS
Thread size			M 4	M 4	M 5	M 5	M 5	M 6	M	M 6	M 8
Recommended loads in the respective base material F_{rec} ²⁾											
Gypsum plasterboard	9.5 mm	[kN]	0.15	0.15	0.15	0.15	-	0.15	-	-	-
Gypsum plasterboard	12.5 mm	[kN]	0.20	0.20	0.20	0.20	-	0.20	0.20	-	0.20
Gypsum plasterboard	19 mm (2 x 9.5 mm)	[kN]	-	-	-	0.25	-	-	0.25	-	0.25
Gypsum plasterboard	25 mm (2 x 12.5 mm)	[kN]	-	-	-	-	0.30	-	-	0.30	-
Chipboard	10 mm	[kN]	0.25	0.25	0.25	0.25	-	0.25	0.25	-	0.25
Chipboard	13 mm	[kN]	0.25	0.25	0.25	0.25	-	0.25	0.25	-	0.25
Chipboard	28 mm	[kN]	-	-	-	-	0.50	-	-	0.50	-
Plywood	4 mm	[kN]	0.10	-	-	-	-	-	-	-	-
Hardboard	3 mm	[kN]	0.10	-	-	-	-	-	-	-	-
Wood wool slab	16 mm	[kN]	-	0.05	-	0.05	-	-	0.05	-	0.05
Wood wool slab	25 mm	[kN]	-	-	-	-	0.05	-	-	0.05	-
Fibre cement board	8 mm	[kN]	0.25	0.25	0.25	0.25	-	0.25	-	-	-
Gypsum fibreboard	10 mm	[kN]	0.25	0.25	0.25	0.25	-	0.25	0.25	-	0.25
Gypsum fibreboard	15 mm	[kN]	-	0.25	0.25	0.25	-	0.25	0.25	-	0.25

¹⁾ Required safety factors are considered.²⁾ Valid for tensile load, shear load and oblique load under any angle.