

Adjustable fixing S10J

The fixing for infinite adjustment of timber constructions in all standard solid building materials



Stand-off installations

5

Applications

- Substructures made of wooden battens of 20-25 mm thickness.

Certificates



Advantages

- The combination of adjustment plug and spacing screw allows for universal usage in wooden and solid building materials.
- The special operating principle of the

adjustable fixing S10J and the spacing screw allows for infinite adjustment. This saves on the use of wedges and blocks when fixing the fixture.

Building materials

- Concrete
- Wood
- Solid sand-lime brick
- Natural stone with dense structure
- Aerated concrete
- Solid panel made from gypsum
- Solid brick made from lightweight concrete
- Solid brick

Functioning

- The S10J is suitable for push-through installation.
- Once the screw has been screwed in, the fixture distance can be infinitely adjusted by modifying the rotation direction.
- For the fixing of wood on wood, e.g. in the roof truss, only use adjustment screw JS.

Installation S10J

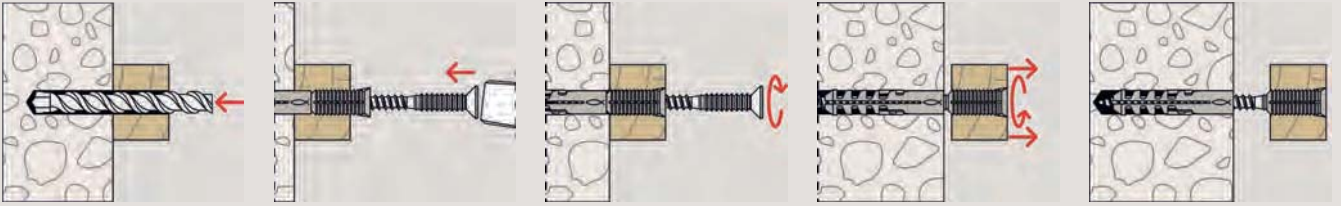

Installation JS

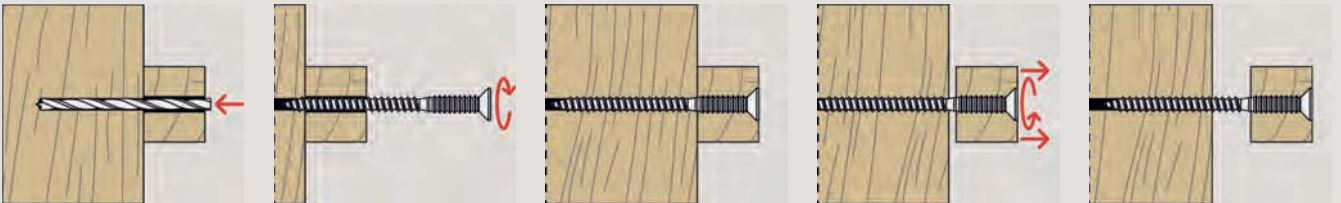

5

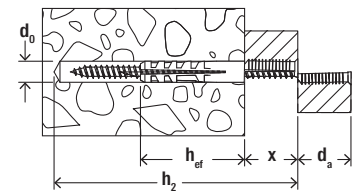

Technical data

Adjustable fixing S10J



S 10 J 75 S

Item	Item No.	Drill hole diameter	Min. drill hole depth for through fixings	Effect. anchorage depth	Screw length	Max. timber thickness	Max. adjustment travel	Sales unit
		d_0 [mm]	h_2 [mm]	h_{ef} [mm]	l_s [mm]	d_a [mm]	x [mm]	[pcs]
S 10 J 75 S	080710	10	115	50	110	25	30	50

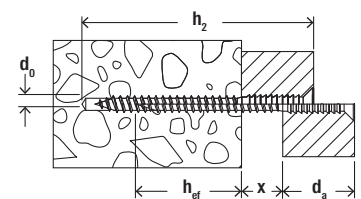

Technical data

Adjustable screw JS



JS

Item	Item No.	Drill hole diameter	Min. drill hole depth for through fixings	Effect. anchorage depth	Screw length	Max. timber thickness	Max. adjustment travel	Sales unit
		d_0 [mm]	h_2 [mm]	h_{ef} [mm]	l_s [mm]	d_a [mm]	x [mm]	[pcs]
JS 6 x 110	080700 ¹⁾	5	50 - 110	30	110	25	55	50

1) min. drill hole depth for push-through installation - depending on wood species