

Brass fixing PA 4

The brass fixing for thin board building materials and solid building materials



Furniture fittings



Furniture hinges

6

Applications

- Handles
- Angle brackets
- Furniture fittings
- Lamps

Advantages

- The short brass fixing PA 4 only requires a very low anchorage depth and is therefore the solution for thin board building materials.
- The special surface structure of the PA 4 prevents the fixing from rotating in the

drill hole. This provides increased installation safety.

- The internal thread allows for the use of standard metric screws and enables the ideal adaptation to suit the intended use.

Building materials

- Wooden board building materials
- Plastic boards
- Concrete
- Solid brick
- Solid sand-lime brick
- Natural stone with dense structure

Functioning

- The PA 4 is suitable for pre-positioned installation.
- Turning in the metric screw causes the front part of the brass fixing to expand, thus securely anchoring it in the substrate.
- Calculating screw length for flush fixing installation: Fixing length + fixture thickness = min. screw length

Installation PA 4

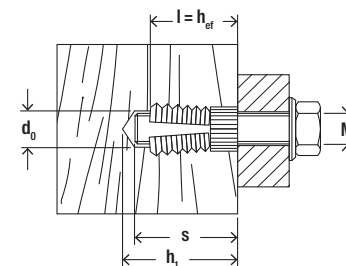
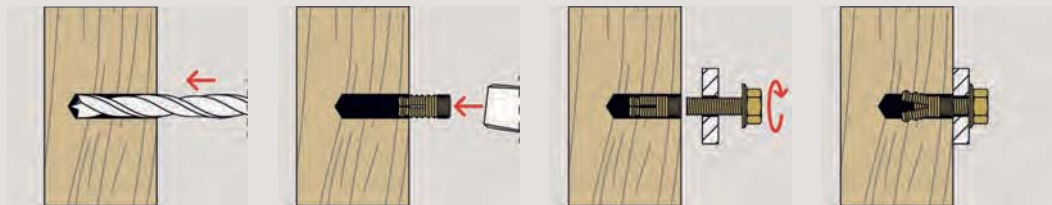

6

Technical data

Brass fixing PA 4



PA4

Item	Item No.	Drill hole diameter d_0 [mm]	Min. drill hole depth h_1 [mm]	Anchor length l [mm]	Thread M	Bolt penetration s [mm]	Effect. anchorage depth h_{ef} [mm]	Sales unit [pcs]
PA 4 M 6/7,5	050484 ¹⁾	8	7,5	7,5	M 6	7,5	7,5	200
PA 4 M 6/10,5	058484 ¹⁾	8	10,5	10,5	M 6	10,5	10,5	100
PA 4 M 6/13,5	059484 ¹⁾	8	13,5	13,5	M 6	13,5	13,5	100
PA 4 M 8/25	050485 ¹⁾	10	25	25	M 8	25	25	50
PA 4 M 10/25	050486 ¹⁾	12	25	25	M 10	25	25	25

¹⁾ Values of drill hole diameter apply for hard building materials. For soft building materials the drill diameter needs to be reduced by 0.5 mm.

Loads

Brass fixing PA 4

Highest recommended loads¹⁾ for a single anchor.
The given loads are valid for metric screws with the specified thread size.

Type		PA 4 M 6/7,5	PA 4 M 6/10,5	PA 4 M 6/13,5	PA 4 M 8/25	PA 4 M 10/25
Thread size	[mm]	M 6	M 6	M 6	M 8	M 10
Recommended loads in the respective base material F_{rec} ²⁾						
Chipboard	[kN]	0.20	0.30	0.40	-	-
Fir wood	[kN]	0.18	0.25	0.38	-	-
Beech wood	[kN]	0.50	0.75	1.00	-	-
Plastic material	[kN]	0.75	1.50	2.00	-	-
Solid brick	Mz 12 [kN]	-	-	0.80	1.95	2.30

¹⁾ Required safety factors are considered.

²⁾ Valid for tensile load, shear load and oblique load under any angle.