

# Render fixing DIPK

The cost-effective hammer-set anchor with plastic nail



Pressure-resistant insulation boards with rendering

## Applications

To fix pressure-resistant insulating materials in façades, such as:

- Polystyrene boards
- Light building boards made of wood wool
- Cork boards / coir matting
- PU panels

## Advantages

- The glass-fibre-reinforced plastic nail (GRP nail) reduces the heat transmission and prevents marks on the plaster surface.
- The simple hammer-set installation allows for a quick installation process and thus reduces workload.
- The well-proven design with low anchor-

age depth reduces the amount of drilling required, thus achieving a high level of efficiency.

- The DIPK can be used universally in rear-ventilated curtain façades, as well as in plaster façades.
- The surface of the anchor plate is suitable to use as a plaster base

## Building materials

- Concrete
- Hollow blocks made from lightweight concrete
- Vertically perforated brick
- Perforated sand-lime brick
- Solid sand-lime brick
- Natural stone with dense structure
- Solid brick

## Functioning

- Non-bearing layers, such as adhesive and/or old render, are to be included in the anchor's useful length.
- The DIPK is set in push-through installation using a hammer.
- In solid materials the GRP nail needs to be shortened at the predetermined breaking point.
- Driving the nail into the anchor shaft causes the DIPK to expand in the base material.

### Installation DIPK in concrete

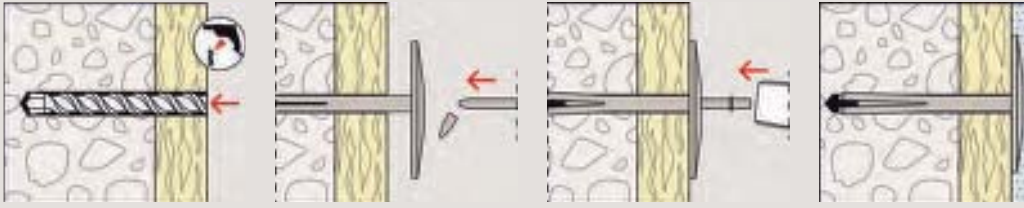

### Installation DIPK in masonry

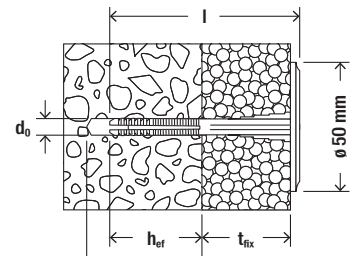
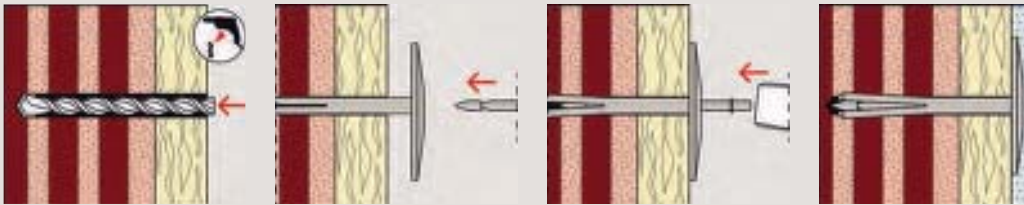

11

### Technical data

#### Render fixing DIPK



DIPK

Item	Item No.	Drill hole diameter		Usable length		Min. drill hole depth		Effect. anchorage depth		Fixing length		Sales unit	
		$d_0$ [mm]		$t_{fix}$ [mm]		$h_1$ [mm]		$h_{ef}$ [mm]		$l$ [mm]		[pcs]	
DIPK 8/20-40	041865	8		20 - 40		40		30		70		200	
DIPK 8/40-60	041866	8		40 - 60		40		30		90		200	
DIPK 8/60-80	041867	8		60 - 80		40		30		110		200	
DIPK 8/80-100	041868	8		80 - 100		40		30		130		200	
DIPK 8/100-120	041869	8		110 - 120		40		30		150		200	
DIPK 10/10-30	043966	10		10 - 30		40		30		60		200	
DIPK 10/40-60	043967	10		40 - 60		40		30		90		200	
DIPK 10/60-80	043968	10		60 - 80		40		30		110		200	
DIPK 10/80-100	043969	10		80 - 100		40		30		130		200	
DIPK 10/100-120	043970	10		110 - 120		40		30		150		200	
DIPK 10/120-140	043971 <sup>1)</sup>	10		120 - 140		40		30		170		200	
DIPK 10/140-160	043972 <sup>1)</sup>	10		140 - 160		40		30		190		200	

<sup>1)</sup> Installation with setting tool, included in each package.